

A0716 Composite Manholes

- Built-In Handle
- Reduced Weight
- H-20 Wheel Loading
- Slip-Resistant Tread Pattern



18"



39" & 44"

42"



- Dual Handle - spring-loaded and key-lift
- Pry Bar Cleat - provides an access for pry bar and eliminates lid chips
- Cam lock is etched to show open and close directional arrows
- Powder-coated cast iron cam with o-ring

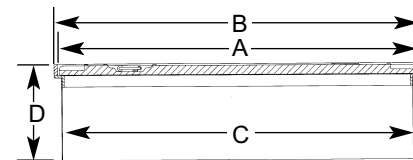

Lightweight, durable, fiberglass reinforced lids for your entire tank

Submersible Pump Tank Sump
39", 42" & 44" Composite Manholes

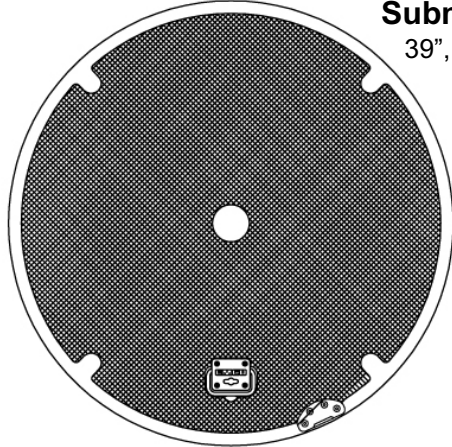

Tank Gauging Equipment
18" Composite Manhole

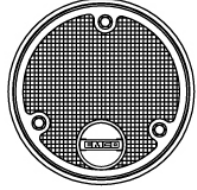

Spill Containment
5 Gallon Capacity

	Part Number	Style	Lid Dia. A	Overall Dia. B	Clear Hole ID C	Overall Height D	Drop-In Replacement for:	
							OPW	Franklin
18"	A0716-018	Lay-in	17.0"	17.9"	15.9"	10.0"		
	A0716-018A	Lay-in	17.0"	17.9"	15.9"	18.0"		
	A0716-018BA	Bolt-Down	17.0"	17.9"	13.9"	18.0"		
	A0716-018B	Bolt-Down	17.0"	17.9"	13.9"	10.0"		
	A0716-018L	Lid Only	17.0"	--	--	--		
39"	A0716-039	Lay-in	39.5"	40.9"	37.8"	10.1"	39CD-PL10	781-433-13
	A0716-039B	Bolt-Down	39.5"	40.9"	35.5"	10.1"		
	A0716-039C	Cam Lock	39.5"	40.9"	36.8"	10.1"		
	A0716-039L	Lid Only	39.5"	--	--	--	P39CD-PL10	781-448-06
	A0716-039CL	Lid Only	39.5"	--	--	--		
	A0716-039G	Lay-in, Grey Lid	39.5"	40.9"	37.8"	10.1"	39CD-PL10	781-433-13
	A0716-039BG	Bolt-Down, Grey Lid	39.5"	40.9"	34.2"	10.1"		
	A0716-039CG	Cam Lock, Grey Lid	39.5"	40.9"	36.8"	10.1"		
A0716-039LG	Lid Only, Grey Lid	39.5"	--	--	--	P39CD-PL10	781-448-06	
A0716-039CLG	Lid Only, Grey Lid	39.5"	--	--	--			
42"	A0716-042	Lay-in	43.8"	45.2"	42.0"	10.1"		
	A0716-042C	Cam Lock	43.8"	45.2"	41.0"	10.1"		
	A0716-042L	Lid Only	43.8"	--	--	--		
	A0716-042CL	Lid Only	43.8"	--	--	--		
44"	A0716-044	Lay-in	44.3"	45.7"	42.5"	10.1"	44CD-PL10	781-443-13
	A0716-044B	Bolt-Down	44.3"	45.7"	40.3"	10.1"		
	A0716-044C	Cam Lock	44.3"	45.7"	41.5"	10.1"		
	A0716-044L	Lid Only	44.3"	--	--	--	P44CD-PL10	
	A0716-044CL	Lid Only	44.3"	--	--	--	P44CD-RL10	

Custom skirt heights available